

LDY2002 系列

气动法兰角座阀

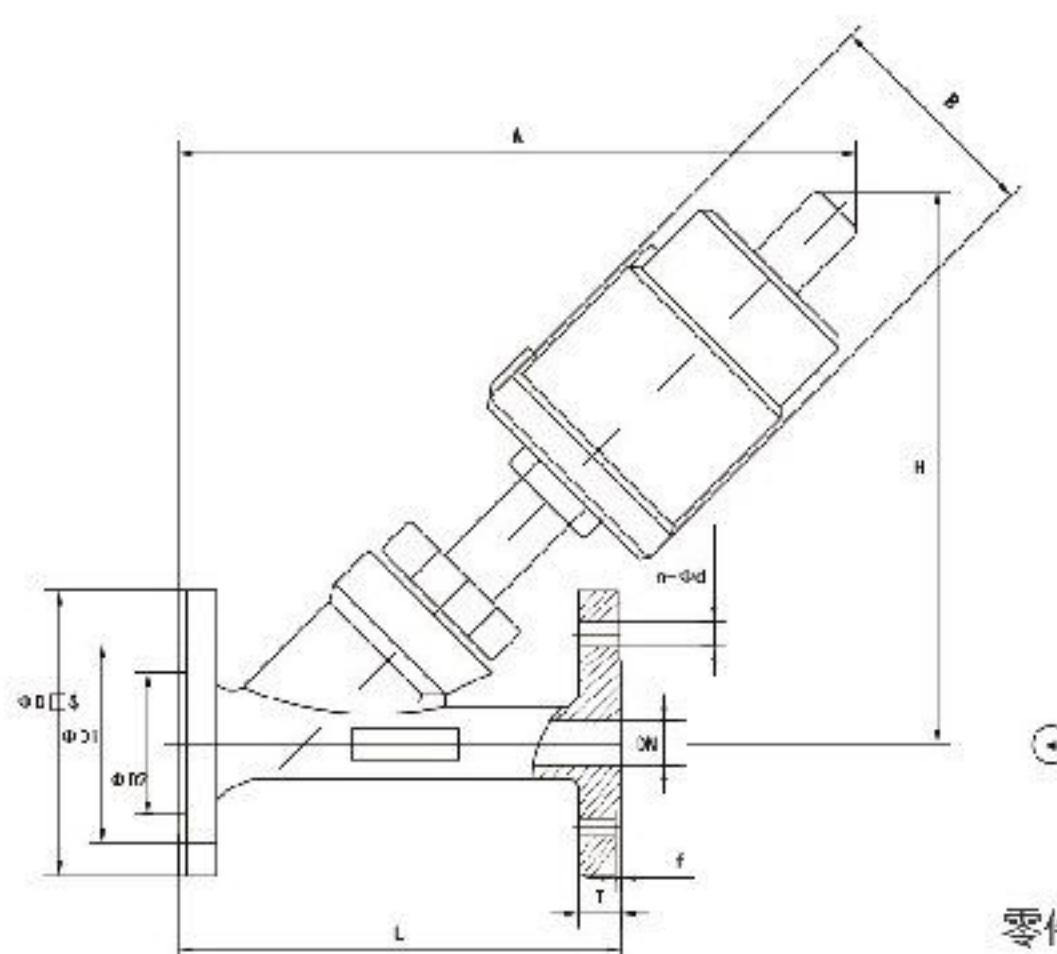

零件结构 (图一)

技术参数 Technical Parameters

| | |
|--------------------------|--|
| 管道压力 Fluid Pressure | Max 1.6Mpa (232 psi) |
| 控制压力 Control Pressure | 0.3-0.8Mpa (43.5-116psi) |
| 控制介质 Control Medium | 中性气体或空气 Neutral gas or Air |
| 阀体材料 Body Material | CF8M/CF8 |
| 密封材料 Seals Material | PIH |
| 气缸材料 Actuator Material | CF8 |
| 气缸尺寸 Actuator Size | 50mm , 63mm , 80mm , 100mm |
| 适用介质 Applicable Medium | 水,酒精,油,燃料,蒸汽,中性气体或液体,有机溶剂,酸碱溶液 Water , Alcohol , Oil , Fuel , Steam , Neutral gas or liquid , Organic , Solvent , Acid and lye |
| 介质粘度 Medium Viscosity | Max 600mm ² /S |
| 介质温度 Medium Temperature | -10℃ - +180℃ |
| 环境温度 Ambient Temperature | -10℃ - +80℃ |
| 控制形式 Control Type | 标准常闭、常开、双作用 Normally closed , Normally open , Double acting |
| 连接形式 Connection | 螺纹式, 焊接式, 法兰式, 快装式 Threaded (BSP , NPT) , Welded , Flanged , Tei-Clap |

特点 : Advantages

| | |
|------------------------------------|---|
| 流量大、流阻小、无水锤 | Large flux , low resistance , no water-hammer |
| Y型设计, 增加 30% 流量 | Y-type shape enlarged the flowing section, which could raise the flux by 30% and make flow more smooth. |
| 超长使用寿命 | Super Long Life |
| 阀杆自动校正, 自润滑, 免维护 | Which help the stem adjust and lubricate itself automatically. |
| 气缸采用不锈钢材质, 在恶劣的环境中更加优秀, 可 360° 旋转。 | The cylinder material is stainless steel Lubricating automatically , 360° rolling freely. |

外形尺寸 Dimension

(图一)

| 型号 Model | DN | L | T | f | D | D1 | D2 | H | A | B | n-Φd | 执行器 Actuator |
|------------|----|-----|----|---|-----|-----|-----|-----|-----|-----|-------|--------------|
| LDY2002/15 | 15 | 120 | 14 | 2 | 95 | 65 | 40 | 145 | 185 | 62 | 4-Φ14 | Φ50 |
| LDY2002/20 | 20 | 130 | 14 | 2 | 105 | 75 | 50 | 155 | 188 | 62 | 4-Φ14 | Φ50 |
| LDY2002/25 | 25 | 140 | 14 | 2 | 115 | 85 | 60 | 158 | 198 | 62 | 4-Φ14 | Φ50 |
| LDY2002/32 | 32 | 150 | 16 | 2 | 135 | 100 | 70 | 195 | 225 | 76 | 4-Φ18 | Φ63 |
| LDY2002/40 | 40 | 180 | 16 | 2 | 145 | 110 | 80 | 205 | 240 | 76 | 4-Φ18 | Φ63 |
| LDY2002/50 | 50 | 195 | 16 | 2 | 160 | 125 | 92 | 208 | 255 | 76 | 4-Φ18 | Φ63 |
| LDY2002/50 | 50 | 195 | 16 | 2 | 160 | 125 | 92 | 220 | 270 | 96 | 4-Φ18 | Φ80 |
| LDY2002/50 | 50 | 195 | 16 | 2 | 160 | 125 | 92 | 262 | 290 | 114 | 4-Φ18 | Φ100 |
| LDY2002/65 | 65 | 230 | 18 | 2 | 185 | 145 | 115 | 292 | 320 | 114 | 4-Φ18 | Φ100 |