

# LDBAAKP 系列

## 气动 UPVC 双由令球阀



超低扭矩 美观 高强度 耐腐蚀 长寿命

Ultra low torque beautiful high strength and corrosion resistant of long-lived

全流量, PTEE 球密封, 低扭矩  
可使用手柄调节阀座松紧  
松开由令, 中部仍是完整阀门, 可更换  
提供附带平台预埋铜质螺母产品  
方便加装自动执行器

Full flow, PTEE ball sealing, low torque  
Can use the handle regulating valve seat tightness  
Released by the center section is still intact, valves, replaceable  
To provide supplementary platform embedded copper nut products  
Convenient automatic actuator

### 技术参数 Technical Parameters

|                                |                                                                               |
|--------------------------------|-------------------------------------------------------------------------------|
| 气缸形式 Cylinder Type             | 双作用、单作用 Dual action actuator、Spring return action                             |
| 环境温度 Environmental Temperature | -20°C ~ +80°C                                                                 |
| 气源压力 Air Pressure              | 双作用 4~8bar、单作用 5~8bar Dual action actuator 4~8bar、Spring return action 5~8bar |

### 功能选项 Function Options

|                           |                                                                           |
|---------------------------|---------------------------------------------------------------------------|
| 防爆型 Explosion Proof Model | 防爆等级 :dIIBT4 Explosion-proof class: dIIBT4                                |
| 信号反馈 Signal Feedback      | X1 机械式无源信号, X2 有源信号 X1 mechanical passive signal, X2 active signal        |
| 手动功能 Manual function      | 气动阀可选手轮、手动开阀、关阀功能 Optional wheel, manual switch~&close valve function     |
| 调节型 Regulation Model      | 输入 4~20mA 信号, 实现球阀调节功能 4~20mA input signal, realizing adjustment function |

### 标准规范 Specification Standard

|                        |                             |
|------------------------|-----------------------------|
| 规格 Specifications      | DN150 - DN100 ( 1/2" -4")   |
| 工作压力 Working pressure  | 10kg/cm <sup>2</sup>        |
| 材质 Texture of material | PVC、CPVC、PPG/FRPP、PPH       |
| 标准 Standard            | 国际 GB 德标 DIN 美标 ANSI 日标 JIS |
| 标准 Standard            | 台湾地区 CNS PT NPT             |

### 阀体参数 Body Parameters

|                          |                           |
|--------------------------|---------------------------|
| 公称压力 Nominal Pressure    | PN10                      |
| 连接方式 Connection Method   | 内螺纹 internal threads      |
| 阀体材质 Valve Body Material | UPVC, CPVC, PP, PVDF, ABS |
| 阀杆材质 Tem Material        | UPVC, CPVC, PP, PVDF, ABS |
| 密封材料 Sealing Material    | PTFE                      |
| 球体材质 Ball Material       | UPVC, CPVC, PP, PVDF, ABS |
| 工作温度 Working Temperature | C1: -20°C ~ 80°C ( S)     |

※ 注：球阀结构长度及连接法兰尺寸可根据用户要求设计制造

Note : The structural length and connecting flange size of ball valve series can be designed and manufactured as per users' requirements.



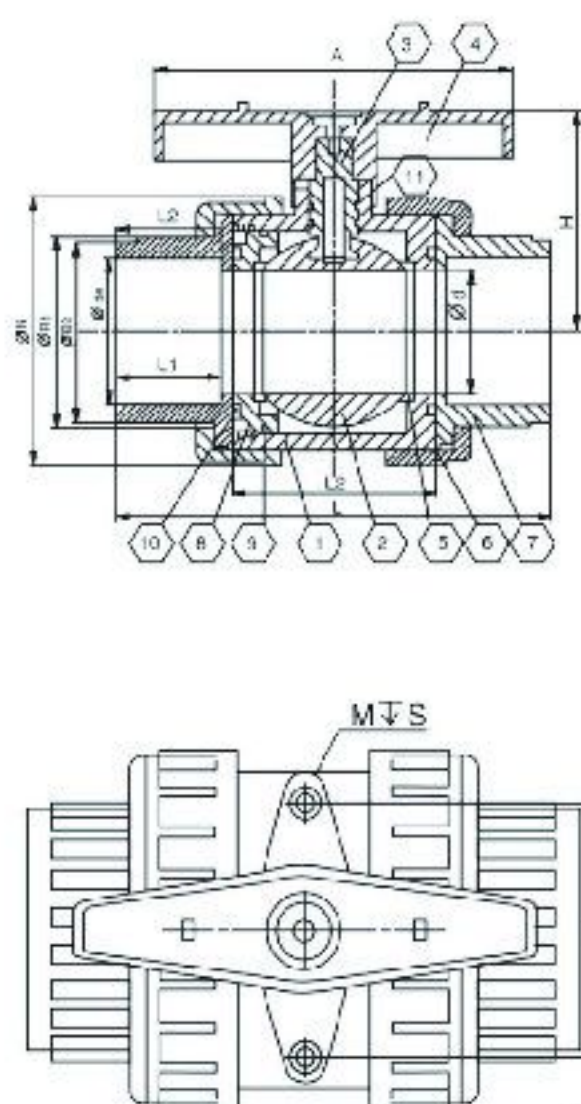

外观尺寸 (图二)

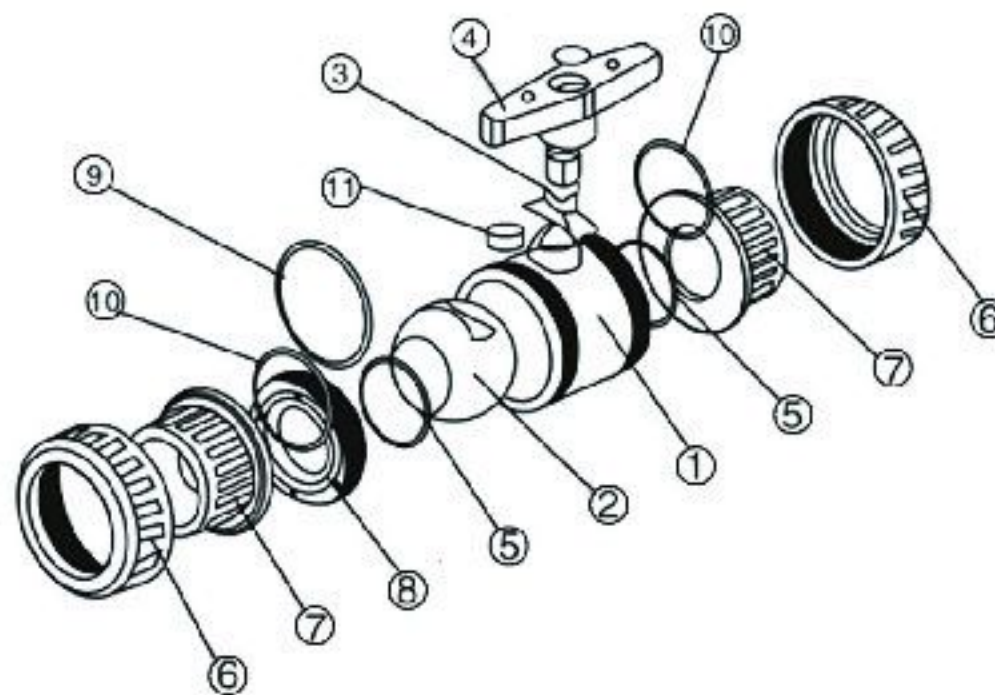

零件结构 (图一)

零件结构材质表 Form of Main Parts Materials

(图一)

| 序号 No. | 零件名称 Name of parts | 材质 Material         |
|--------|--------------------|---------------------|
| 1      | 阀体 Body            | PVC/CPVC/PPG/PPHABS |
| 2      | 球体 Ball            | PVC/CPVC/PPG/PPHABS |
| 3      | 阀杆 tem             | PVC/CPVC/PPG/PPHABS |
| 4      | 手柄 Handle          | ABS                 |
| 5      | 球密封 Seat seal      | PIFE                |
| 6      | 锁母 Union nut       | PVC/CPVC/PPG/PPHABS |
| 7      | 接管 Endconnector    | PVC/CPVC/PPG/PPHABS |
| 8      | 密封支架 Seal carrier  | PVC/CPVC/PPG/PPHABS |
| 9      | 型环 O-Ring O        | EPDM/PPM            |
| 10     | 型环 O-Ring O        | EPDM/PPM            |
| 11     | 型环 O-Ring O        | EPDM/PPM            |

主要外形连接尺寸 Q61 ( 6、8、2 ) 1F ( N、P、Y )-PN16~64 ( 1.6~6.4MPa) Main Outline and Connecting Flange Size

(图二)

| 型号 Model   | DN  | in     | d   | l   | H   | l1 | l2  | NID/de | A   | B   | B1  | B2  | MXS   | F   |
|------------|-----|--------|-----|-----|-----|----|-----|--------|-----|-----|-----|-----|-------|-----|
| LDBAAKP15  | 15  | 1/2"   | 15  | 99  | 50  | 21 | 47  | 20     | 72  | 54  | 34  | 32  | 3x7   | 30  |
| LDBAAKP20  | 20  | 3/4"   | 20  | 117 | 61  | 25 | 54  | 25     | 78  | 62  | 40  | 37  | 6x8   | 33  |
| LDBAAKP25  | 25  | 1"     | 25  | 132 | 68  | 29 | 62  | 32     | 85  | 72  | 47  | 45  | 6x11  | 40  |
| LDBAAKP32  | 32  | 1-1/4" | 30  | 142 | 80  | 29 | 69  | 40     | 88  | 84  | 57  | 55  | 8x11  | 47  |
| LDBAAKP40  | 40  | 1-1/2" | 38  | 158 | 89  | 31 | 80  | 50     | 108 | 95  | 64  | 61  | 8x11  | 52  |
| LDBAAKP50  | 50  | 2"     | 48  | 176 | 103 | 38 | 85  | 63     | 133 | 116 | 77  | 75  | 8x15  | 70  |
| LDBAAKP65  | 65  | 2-1/2" | 65  | 256 | 128 | 58 | 124 | 75     | 220 | 147 | 97  | 90  | 10x15 | 95  |
| LDBAAKP80  | 80  | 3"     | 76  | 266 | 135 | 64 | 124 | 90     | 220 | 164 | 116 | 112 | 10x15 | 120 |
| LDBAAKP100 | 100 | 4"     | 100 | 337 | 163 | 90 | 139 | 100    | 250 | 204 | 137 | 131 | 12x20 | 150 |

※ 注：球阀结构长度及连接法兰尺寸可根据 JB/T79 标准或用户要求设计制作。

※ 注：执行器型号 XXX/XXX 分别是气动执行器双作用式 / 单作用式 ( 弹簧复位 )。

※ 注：根据不同阀门扭矩、使用介质适配的执行器型号可能有所不同，相关尺寸随之变化。

※ 注：以上执行器配置及数据均采用软密封 ( F、N、P ) 阀门，硬密封阀门的配置及数据请咨询本公司。

Note: The structural length and connecting flange size of ball valve series can be designed and manufactured as per JB/T79 standard or users' requirements.

Note: Date XXX/XXX represent respectively the double-acting/single-acting type (spring reposition) of pneumatic actuator.

Note: The relative sizes are subject to change responding to the difference in valve torque, medium and actuator model.

Note: The above actuator configuration and data all use soft-seal valves (F, N, P) and hard-seal valves, or consulting us if you have more questions.